

| | |
|-------------------------------------|---|
| "Supplier logo if available" | Product Technical data sheet: Supplier Declaration |
|-------------------------------------|---|

| Product identification | | |
|------------------------|---------------|--------------|
| ADEO ref | Product EAN | Supplier ref |
| 2022R10P03A-0090 | 3276007359312 | ST52-A0090 |
| 2022R10P03B-0090 | 3276007359398 | ST52-B0090 |

| Template version history | | | |
|--------------------------|------------------------|-------------|-----------------------|
| Version | Status | Date Status | Comments |
| V.0 | Under construction | 20/08/2018 | Template construction |
| V.1 | Validated construction | 30/09/2019 | Validated Template |
| | | | |
| | | | |

Object

Technical data sheet of products

Technical data

Zhangjiagang City Xinhui Import And Export Trading Co.,Ltd

NO.3 Yuefeng Road, Economic Development Zone, Zhangjiagang City, Jiangsu Province, China 215600

The table information,pls see the see technical drawing.

| | | | |
|--|--|--|--|
| Name product | | Contain battery | |
| Power in Watt | | Weight of the battery (gram) | |
| Nett Weight in gram (without batteries, without packaging) | | Type of battery (Li-ion / Alkaline, ...) | |
| Size of product: LxHxW in centimetre | | | |
| Accessories included: detailed it | | | |
| Weight packaging | | | |
| Size packaging | | | |
| | | | |
| | | | |

Remark: The main technical features could be adjusted by supplier based on different kinds of products.

Technical drawing

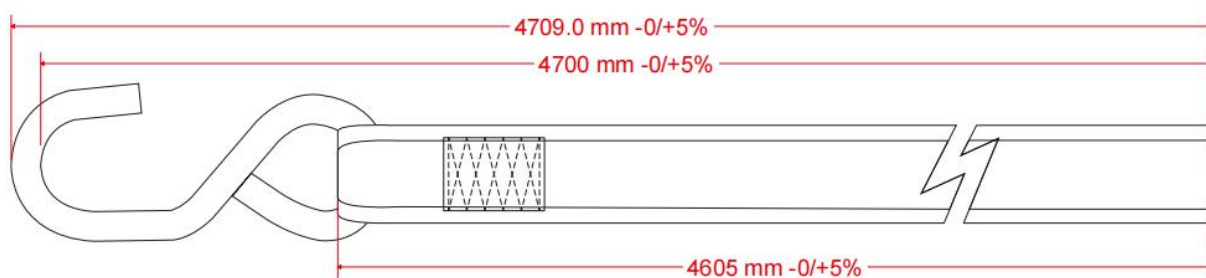
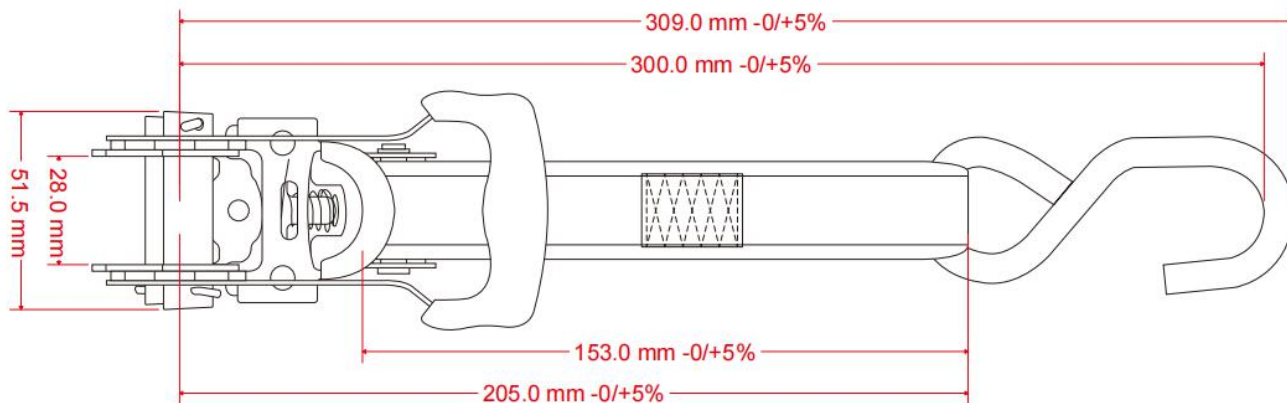
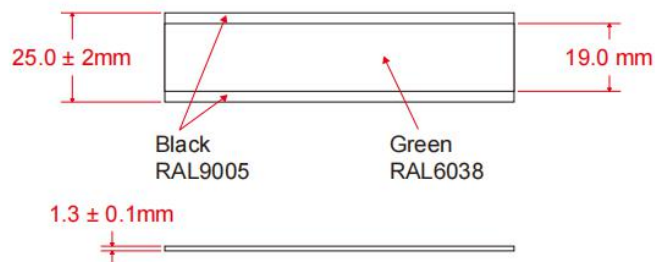
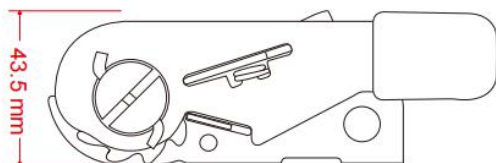
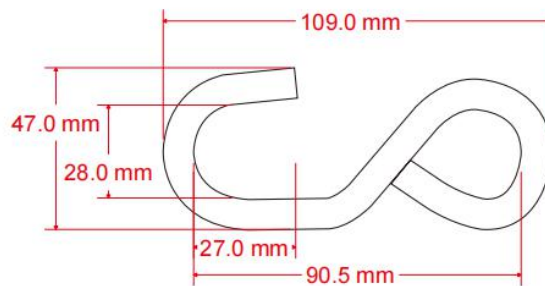
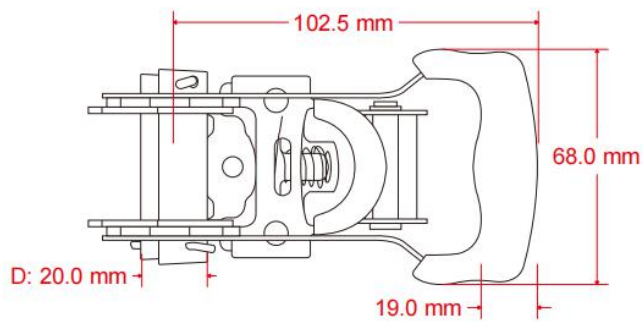

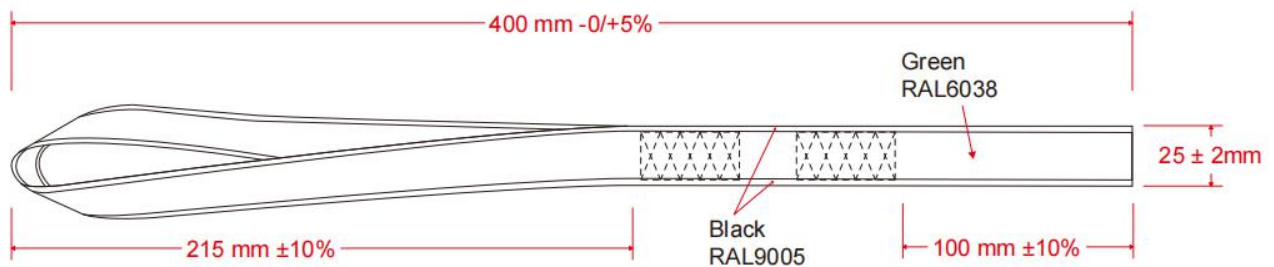
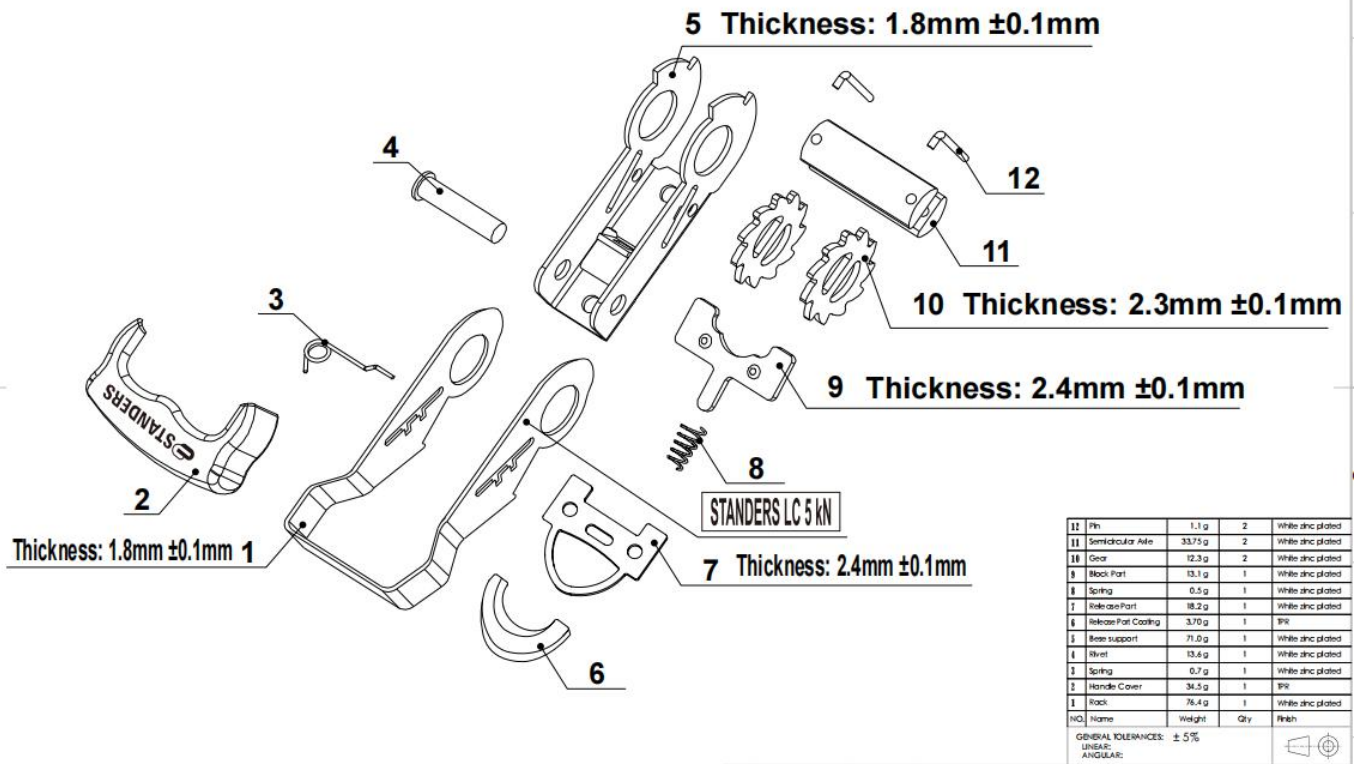

Packaging information:

| | Unit - Gross Weight | Unit - Net Weight | Unit - Length(cm) | Unit - Width (cm) | Unit - Height (cm) | Code |
|--|---------------------------|-------------------------|----------------------|-------------------------|--------------------------|------|
| | | | | | | |

| | (kg) | (kg) | | | | |
|------------------|------|------|------|------|---|------|
| 2022R10P03A-0090 | 2.9 | 2.88 | 25.5 | 22.5 | 7 | ST52 |
| 2022R10P03B-0090 | 2.9 | 2.88 | 25.5 | 22.5 | 7 | ST52 |